

## Installation Manual - INSULATION BOARD

**IMPORTANT: DO NOT** use solvent based adhesives with this product.

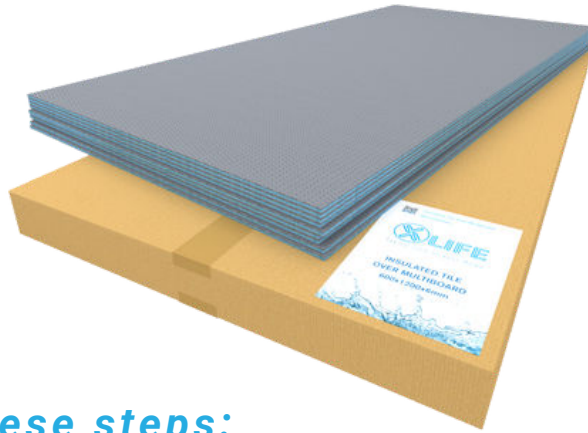

**Xlife** Insulation Board sheets are sized at 1200 x 600 x 6mm, with each sheet capable of covering around 0.72 square meters. Each box contains 10 pieces, providing coverage for a total of 7.2 square meters.

*Please follow these steps:*

**Floor Preparation:** Before priming, it's essential to clean the concrete floor, remove contaminants, and ensure they are smooth. Get rid of all dust, dirt, and impurities. Then, follow the adhesive manufacturer's instructions for applying the primer.

### Concrete Floors



#### Measure and Trim the Xlife Boards

Using a regular knife or a jigsaw, trim the Boards to match the room's shape, making sure to stagger the joints.



### **Lay in an Offset "Brick" Pattern**

Once you've carefully positioned the Boards according to the picture, ensuring everything is in its proper place, it's time to start the gluing process.

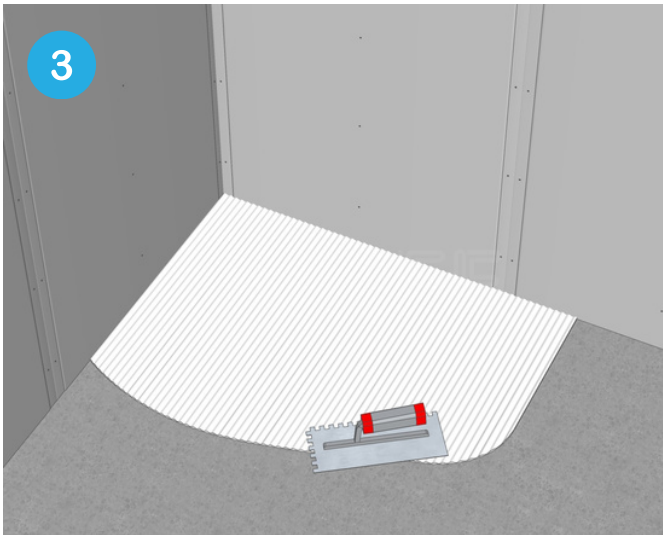

### **Apply a Standard Tile Adhesive for Concrete.**

In accordance with the instructions on the adhesive manufacturer's packaging, evenly apply the adhesive to achieve complete coverage across the entire surface, preferably utilizing an 8mm notch trowel.

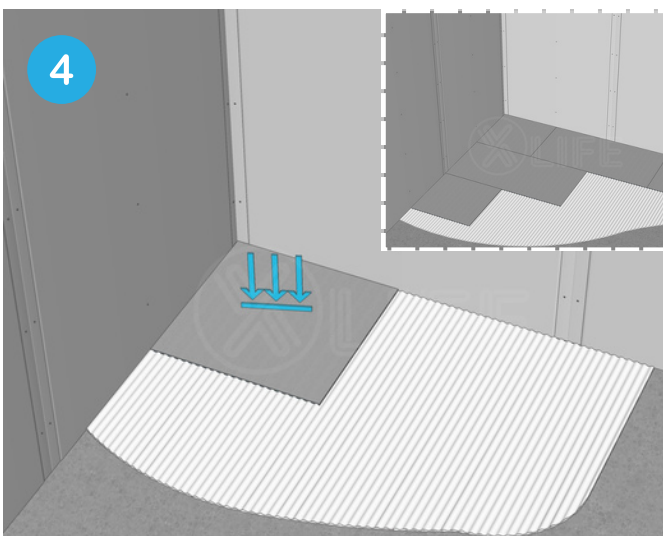

### **Install the Xlife Boards**

Return the Boards to its original spot. Apply enough pressure to remove any air pockets underneath, but not too much that makes the adhesive come out from the edges.

## Timber Floors



### Measure and Trim the Xlife Boards

Using a regular knife or a jigsaw, trim the Boards to match the room's shape, making sure to stagger the joints. Keep in mind, if the floor isn't flat, you might have to trim the sheet corners to prevent them from lifting after gluing.



### Lay in an Offset "Brick" Pattern

Once you've carefully positioned the Boards according to the picture, ensuring everything is in its proper place, it's time to start the gluing process.

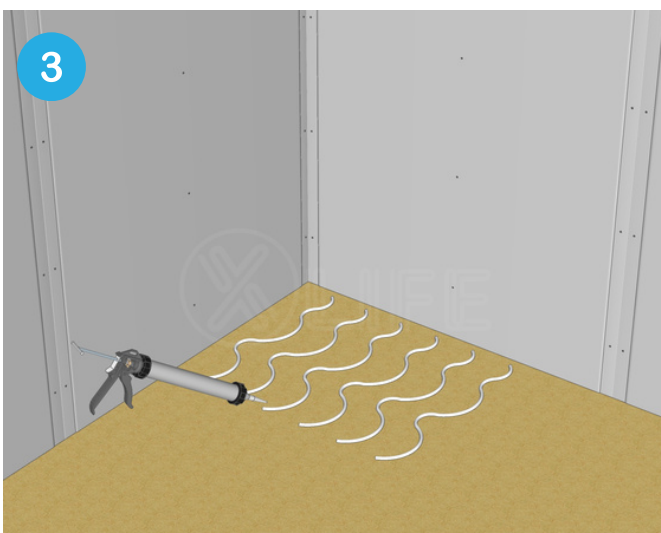

### Apply a Non-Solvent Adhesive Suitable for Timber Floors

In accordance with the instructions on the adhesive manufacturer's packaging, evenly apply the adhesive to achieve complete coverage across the entire surface.

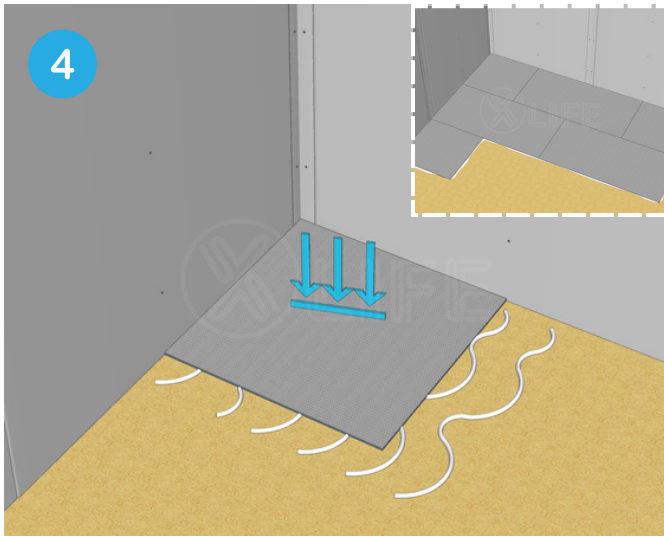

### **Install the Xlife Boards**

Return the Xlife Boards to its original spot and make sure to firmly press it down to eliminate any air gaps underneath.

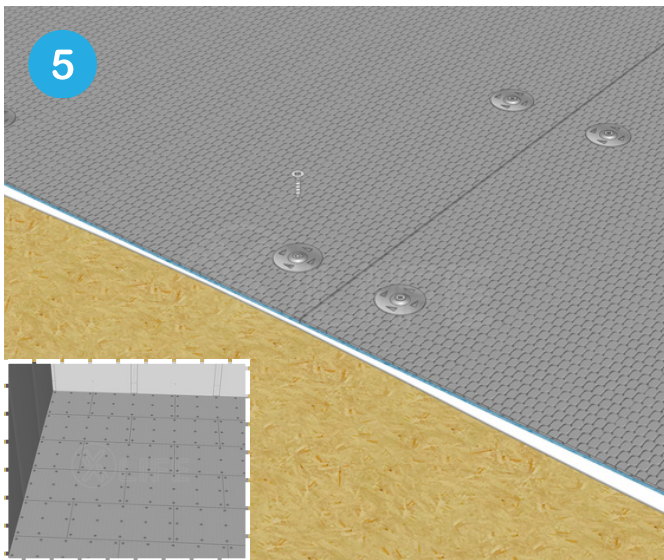

### **Affix the Xlife Boards with Screws**

After applying the adhesive, affix the Boards to the timber floor using screws equipped with 30mm countersunk washers, using around 12 screws for each sheet. Make sure to screw at least 5mm from the edging.

**Important Note:** Please note that this guide provides general installation instructions, but there are various factors that may necessitate adjustments to the installation method.